

PARTS CONVEYOR WITH FEEDER

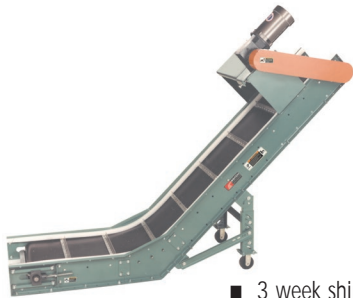

■ 3 week shipment

PRICES INCLUDE

- **BELT:** Black PVC-120 (CXFS) or 1/2" x 1" flat wire mesh belt with 1-1/2" high galvanized cleats on 12" centers
- **BELT SPEED:** 35 fpm, constant
- **DRIVE PULLEY:** 4" dia. with 1-13/16" dia. shaft, crowned and fully lagged with nitrile belt; 4" dia. sprockets supplied with flat wire mesh belt
- **TAKE-UP:** screw type unit at tail pulley provides 12" belt take-up
- **BED:** 8" deep x 12 ga. enclosed box type construction with 14 ga. steel belt return pan
- **ROLLER CHAIN:** no. 50 chain provided at drive pulley; chain take-up provided on motor base
- **1/2 HP SUPER E MOTOR (230/460/3)**
- **PORTABLE SUPPORT:** adjustable floor support with 4" dia. casters and bracing

ANGLE OF INCLINE		30°, 36°, 45°				
BELT	OAW	"A"	"B"	PRICE	WT. (LBS.)	
12"	16"	24"	45"	\$3,561	210	
			54"	\$3,703	219	
			66"	\$3,916	233	
		30"	45"	\$3,682	218	
			54"	\$3,825	228	
			66"	\$4,018	250	
	42"	45"	\$3,877	234		
		54"	\$4,018	243		
		66"	\$4,227	256		
	18"	22"	24"	45"	\$3,863	233
				54"	\$4,039	244
				66"	\$4,258	260
30"			45"	\$3,967	243	
			54"	\$4,160	254	
			66"	\$4,388	270	
42"		45"	\$4,219	261		
		54"	\$4,388	272		
		66"	\$4,619	288		
24"		28"	24"	45"	\$4,580	256
				54"	\$4,832	269
				66"	\$5,152	287
	30"		45"	\$4,742	268	
			54"	\$5,001	281	
			66"	\$5,274	299	
	42"	45"	\$5,081	290		
		54"	\$5,315	303		
		66"	\$5,640	321		

IMPORTANT NOTES

MINIMUM CONVEYOR LENGTH MUST BE TWO TIMES THE BELT WIDTH

SPECIFY PRODUCT SIZE WHEN ORDERING

12" MAXIMUM CLEAT CENTER

"A"				24"	30"	42"
BELT	BF	OAW	"B"	UNIT WEIGHTS (lbs.)		
12"	13"	16"	45"	210	218	234
12"	13"	16"	54"	219	228	243
12"	13"	16"	66"	233	250	256
12"	13"	16"	45"	233	243	261
12"	13"	16"	54"	244	254	272
12"	13"	16"	66"	260	270	288
12"	13"	16"	45"	256	268	290
12"	13"	16"	54"	269	281	303
12"	13"	16"	66"	287	299	321

OPTIONAL SPEEDS						
HP	SPEED					
	10	20	30	40	50	60
1/2	\$1,550	\$1,286	\$114	N/C	N/C	N/C
3/4	\$1,748	\$1,679	\$598	\$318	\$318	\$216
1	N/A	N/A	\$923	\$556	\$485	\$369

Prices in charts are for optional speeds other than 1/2 HP SUPER E Motor (230/460/3).

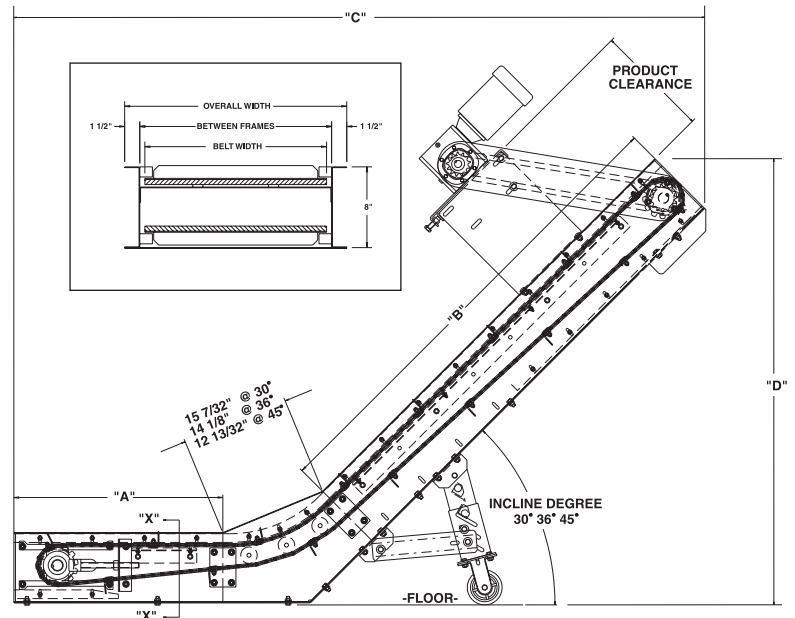

OPTIONAL MOTORS								
MOTOR SERIES	SUPER "E"	SUPER "E" ODP	INVERTER* DUTY	DC*		BRAKE	WASHDOWN	
VOLTAGE	230/460/3	115/230/1	230/460/3	90V	180V	230/460/3	230/460/3	
HP	1/2	N/A	\$120.40	\$196.00	\$543.20	N/A	\$1,092.00	\$599.20
	3/4	N/A	\$200.20	\$210.00	N/A	\$746.20	\$1,271.20	\$616.00
	1	N/A	\$260.40	\$1,132.60	N/A	\$1,015.00	\$1,288.00	\$637.00

* Prices do not include controller. See Electrical Component Controls for pricing.

All Super E brake standard with 230/460/1 brake coils.

OPTIONAL DRIVE ASSEMBLIES	
ASSEMBLY TYPE	PRICE
SIDE MOUNTED	\$194.60

DRIVE OPTION

Motor (Deduct) \$352.80

MISCELLANEOUS POWER CONVEYORS

