

MODEL 192S

1.9" DIA. X 12 GA. GRAVITY ROLLER CONVEYOR



PRICES INCLUDE

- **ROLLERS:** 1.9" x 12 ga. steel tubing, with smooth swaged ends
- **FRAMES:** formed steel painted channel 3-1/2" x 1-1/2" x 10 ga. set high; 4-1/2" x 1-1/2" x 10 ga. set low
- **COUPLINGS:** butt type
- **BEARINGS:** integral plain ball bearings, zinc plated, grease packed
- **ROLLER CAPACITY:** 260 lbs. per roller
- **FRAME CAPACITY:** 1300 lbs. maximum distributed live load per 10' section with supports at 10' centers; 3200 lbs. at 5' centers
- **AXLES:** 7/16" hex shaft, spring loaded

STRAIGHT SECTIONS

BF	3" RC	4½" RC	6" RC	9" RC	12" RC
	10'	10'	10'	10'	10'
13"	\$649.40	\$496.60	\$414.50	\$352.80	\$308.40
15"	\$702.00	\$530.50	\$439.70	\$371.50	\$323.00
17"	\$754.60	\$564.40	\$464.80	\$390.20	\$337.50
19"	\$807.20	\$598.20	\$490.00	\$408.90	\$352.10
21"	\$859.90	\$632.10	\$515.10	\$427.60	\$366.70
23"	\$912.50	\$666.00	\$540.30	\$446.30	\$381.30
25"	\$965.10	\$699.80	\$565.40	\$465.00	\$395.90
27"	\$1,017.70	\$733.70	\$590.60	\$483.70	\$410.40
31"	\$1,122.90	\$801.40	\$640.90	\$521.10	\$439.60
33"	\$1,175.50	\$835.30	\$666.10	\$539.70	\$454.20
37"	\$1,280.70	\$903.00	\$716.40	\$577.10	\$483.30
39"	\$1,333.30	\$936.90	\$741.50	\$595.80	\$497.90
43"	\$1,438.60	\$1,004.60	\$791.80	\$633.20	\$527.10
47"	\$1,543.80	\$1,072.40	\$842.10	\$670.60	\$556.20
51"	\$1,649.00	\$1,140.10	\$892.40	\$708.00	\$585.40

STRAIGHT SECTION MODEL NUMBER 192S-13-3-H-5-S

192S-(between frames)-(roller centers)-(set high or low)-(length)-(add S if structural)

IMPORTANT NOTES

- SPECIAL LENGTHS: Use 10' section per foot, plus \$17 list.
 SPECIAL WIDTHS: For odd width BF price use next widest width

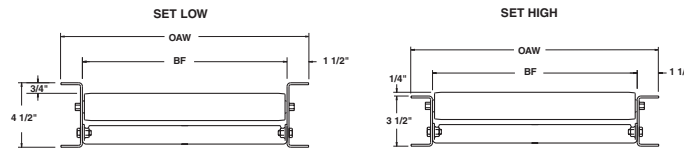

OPTIONAL STRUCTURAL STEEL CHANNEL

4" Structural Steel Frame (Add to base price) \$13 per ft. of conveyor

CURVED SECTIONS



Single roller design



Double roller design

BF / RADIUS	90°			45°		
	ROLLER QUANTITY	ROLLER PATTERN	PRICE	ROLLER QUANTITY	ROLLER PATTERN	PRICE
13"	22	SINGLE	\$552.70	11	SINGLE	\$305.50
15"	22	SINGLE	\$584.30	11	SINGLE	\$319.20
17"	22	SINGLE	\$616.50	11	SINGLE	\$345.30
19"	22	SINGLE	\$649.10	11	SINGLE	\$348.90
21"	22	SINGLE	\$680.30	11	SINGLE	\$362.70
23"	41	DOUBLE	\$1,021.30	21	DOUBLE	\$535.60
25"	41	DOUBLE	\$1,057.30	21	DOUBLE	\$553.70
27"	41	DOUBLE	\$1,093.80	21	DOUBLE	\$574.90
31"	40	DOUBLE	\$1,206.00	20	DOUBLE	\$606.60
33"	40	DOUBLE	\$1,234.90	20	DOUBLE	\$624.20
37"	40	DOUBLE	\$1,295.90	20	DOUBLE	\$659.00
39"	40	DOUBLE	\$1,325.00	20	DOUBLE	\$671.90
43"	40	DOUBLE	\$1,384.60	20	DOUBLE	\$704.50
47"	40	DOUBLE	\$1,444.10	20	DOUBLE	\$737.00
51"	40	DOUBLE	\$1,503.60	20	DOUBLE	\$769.50

CURVED SECTION MODEL NUMBER 192SC-27-H-90

192SC-(between frames)-(set high or low)-(degree)-(add S if structural)

IMPORTANT NOTES

- SPECIAL DEGREE: Less than 45°, use 45° curve price plus \$84 list; Less than 90°, but over 45°, use 90° curve price plus \$84 list.
 SPECIAL WIDTHS: For odd width BF price use next widest width

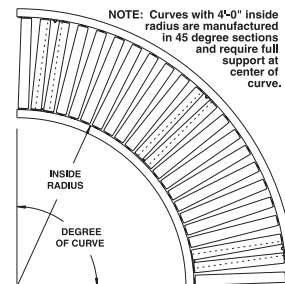

OPTIONAL STRUCTURAL STEEL CHANNEL

4" Structural Steel Frame (Add to base price for 90° & 45°) \$177

CAUTION: Use connector brackets with safety pop-out rollers to prevent pinch points that exist when gravity conveyors are permanently attached to power conveyors. See Gravity Accessories section.